

RESOLUTION NO. 071688

**BOARD OF SUPERVISORS, COUNTY OF SAN MATEO, STATE OF CALIFORNIA
ACTING AS THE GOVERNING BOARD OF THE FAIR OAKS SEWER
MAINTENANCE DISTRICT**

* * * * *

RESOLUTION:

- 1. ORDERING THE ANNEXATION OF THE LANDS OF YOHO
(215 LINDENBROOK ROAD, WOODSIDE, APN 073-071-200) TO THE
FAIR OAKS SEWER MAINTENANCE DISTRICT; AND**
- 2. DIRECTING THE DIRECTOR OF PUBLIC WORKS TO TRANSMIT A COPY OF
THE RESOLUTION ORDERING ANNEXATION TO THE TOWN OF WOODSIDE AND
FILE MAPS OF SAID ANNEXATION WITH THE APPROPRIATE AGENCIES**

RESOLVED, by the Board of Supervisors of the County of San Mateo, State of California, acting as the governing board of the Fair Oaks Sewer Maintenance District, that

WHEREAS, on Tuesday, September 27, 2011, this Board adopted its Resolution of Intention No. 071649, to annex the property at 215 Lindenbrook Road (APN 073-071-200) to the Fair Oaks Sewer Maintenance District (District), a maintenance district organized and existing under and pursuant to Section 5820 et. seq. of the Streets and Highways Code, said property being more particularly described in Exhibit "A" attached hereto; and

WHEREAS, a copy of Exhibit "B" from said Resolution, headed by the words "NOTICE OF HEARING" was published once a week for two successive weeks prior to the date set for the hearing in a local newspaper of general circulation in the above named District, and in the territory proposed to be annexed, deemed by this Board to be most likely to give Notice of Hearing to all inhabitants of each, and copies of Exhibit "B"

071688

from said Resolution with like heading in letters of not less than one inch in height were also posted in three conspicuous places within the territory proposed to be annexed, not less than ten days prior to the day set for public hearing; and

WHEREAS, a full public hearing was held thereon at the time and on the date appointed and all persons desiring to be heard were fully heard by this Board.

NOW THEREFORE, IT IS HEREBY DETERMINED AND ORDERED that:

1. All written protests and other written communications were publicly read at said public hearing and all persons desiring to be heard were fully heard and that all protests to the inclusion of said property in the territory, if any, be, and each of them are hereby overruled.
2. Subject to the conditions set forth herein, the boundaries of the District are hereby altered to include said property, as the property so annexed is not within the boundaries of any other sewer maintenance district, is situated in the Town of Woodside, and is more particularly described in Exhibit "A" attached hereto.
3. The Director of Public Works is hereby authorized and directed to:
 - a. file with the County Assessor and the State Board of Equalization statements of the annexation of said territory setting forth the legal description of the boundary thereof, together with said maps and plats prepared by the Director of Public Works pursuant to Sections 54900 and 54904, inclusive, of the Government Code; and

- b. transmit to the Town of Woodside statements of the annexation of said territory, together with a copy of the executed Resolution ordering the annexation.

* * * * *

Exhibit "A"

PROPOSED ANNEXATION OF THE LANDS OF YOHO TO THE FAIR OAKS SEWER MAINTENANCE DISTRICT

215 LINDENBROOK ROAD, WOODSIDE
(APN 073-071-200)

All that certain real property situate in the Town of Woodside, San Mateo County, State of California, described as follows:

Being a portion of the Rancho De Las Pulgas, more particularly described as follows:

All of Parcel 1, as shown on the Parcel Map entitled "Lands of W. G. and E. F. Dougherty", Land Division Map No. 156", filed February 18, 1971, in Volume 11 of Parcel Maps, at Page 52, in the office of the County Recorder of San Mateo County, State of California, more particularly described as follows:

Beginning at the most southerly corner of said Parcel 1 (11PM 52), said point being on the general northerly boundary line of Fair Oaks Sewer Maintenance District, as established by Resolution Number 62288, passed and adopted on September 29, 1998; thence along said Parcel 1 (11PM 52), the following 21 courses:

- (1) Along said boundary line (Resolution Number 62288), North 76°42'00" West, 223.84 feet,
- (2) Leaving said boundary line (Resolution Number 62288), North 73°08'04" West, 288.43 feet, to a point on the general easterly boundary line of Fair Oaks Sewer Maintenance District, as established by Resolution Number 46335, passed and adopted on November 20, 1984,
- (3) Along last said boundary line (Resolution Number 46335), North 10°56'10" East, 62.16 feet,
- (4) North 48°58'20" East, 24.19 feet,
- (5) North 33°42'10" East, 40.03 feet,
- (6) Leaving said boundary line (Resolution Number 46335), South 72°46'31" East, 104.69 feet,
- (7) North 48°39'45" East, 260.00 feet,

- (8) North 50°00'00" West, 103.50 feet, to a point on the general southerly boundary line of Fair Oaks Sewer Maintenance District, as established by Resolution Number 041791, passed and adopted on December 23, 1980,
- (9) Along last said boundary line (Resolution Number 041791), North 51°34'30" East, 95.27 feet,
- (10) North 86°51'50" East, 20.65 feet,
- (11) South 71°41'15" East, 110.95 feet,
- (12) South 74°10'10" East, 86.32 feet,
- (13) South 72°54'30" East, 33.89 feet,
- (14) Leaving said boundary line (Resolution Number 041791), continuing South 72°54'30" East, 51.12 feet,
- (15) South 0°51'07" West, 109.17 feet,
- (16) South 86°21'58" East, 8.29 feet,
- (17) South 20°05'00" West, 53.93 feet,
- (18) Southwesterly along a tangent curve to the right having a radius of 150.00 feet, through a central angle of 35°20'00", along the arc 92.50 feet,
- (19) South 55°25'00" West, 19.00 feet,
- (20) South 14°15'00" West, 110.00 feet,
- (21) South 19°53'00" West, 84.93 feet, to the POINT OF BEGINNING.

Containing 4.072 acres more or less.

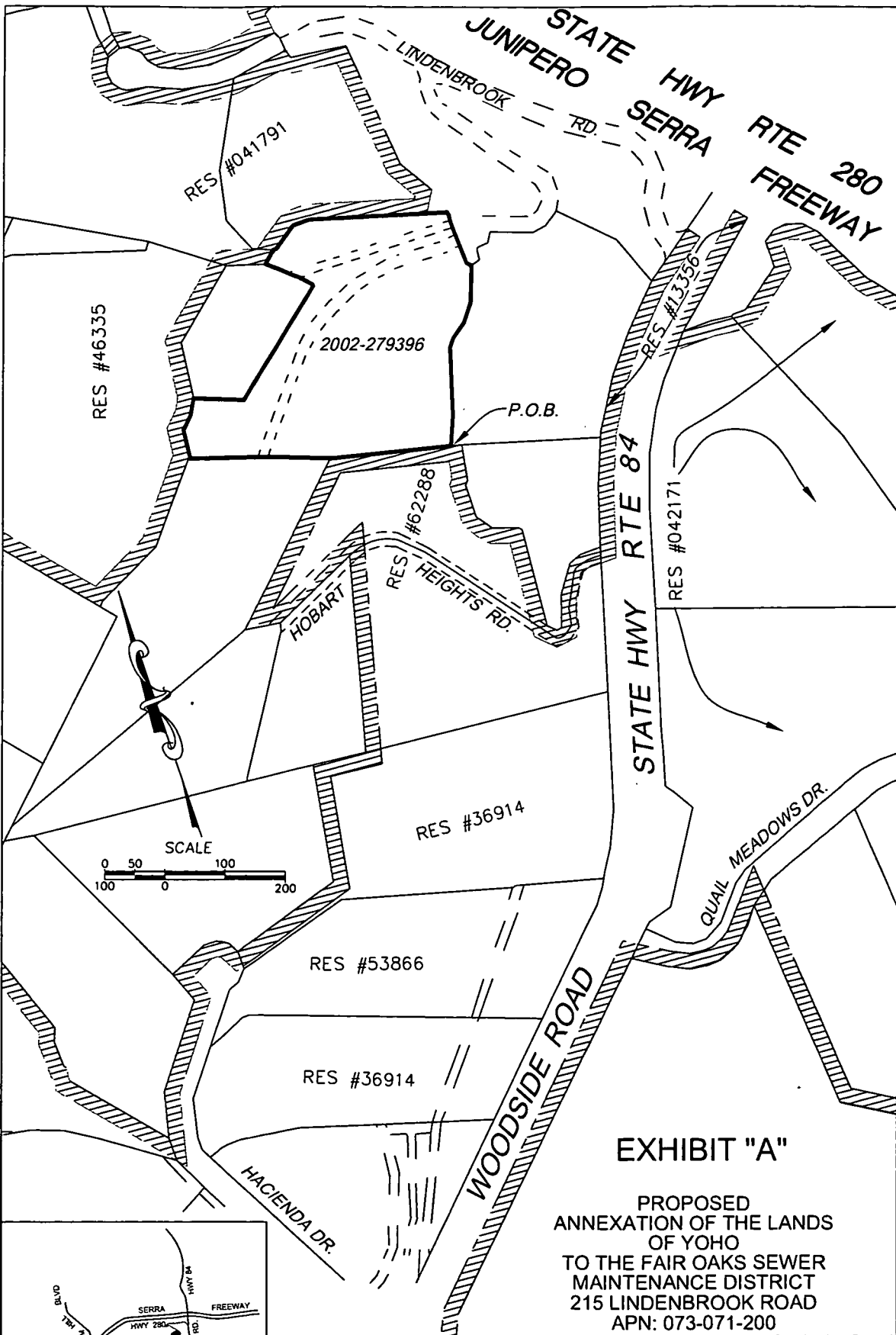
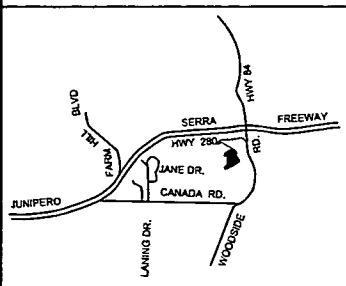

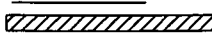

EXHIBIT "A"

PROPOSED
ANNEXATION OF THE LANDS
OF YOHIO
TO THE FAIR OAKS SEWER
MAINTENANCE DISTRICT
215 LINDENBROOK ROAD
APN: 073-071-200



VICINITY MAP
NO SCALE

LEGEND

	EXISTING DISTRICT BOUNDARIES
	PROPOSED ANNEXATION

071688

Regularly passed and adopted this 18th day of October, 2011.

AYES and in favor of said resolution:

Supervisors:

DAVE PINE

CAROLE GROOM

ROSE JACOBS GIBSON

NOES and against said resolution:

Supervisors:

NONE

Absent Supervisors:

DON HORSLEY

ADRIENNE J. TISSIER

Carole Groom

*President, Board of Supervisors
County of San Mateo
State of California*

Certificate of Delivery

I certify that a copy of the original resolution filed in the Office of the Clerk of the Board of Supervisors of San Mateo County has been delivered to the President of the Board of Supervisors.

R. Romero

*Rebecca Romero, Deputy
Clerk of the Board of Supervisors*

071688