

EXHIBIT "A"  
PROPOSED ANNEXATION OF THE LANDS OF DIBBLE  
TO THE FAIR OAKS SEWER MAINTENANCE DISTRICT  
156 BARDET ROAD, WOODSIDE  
(APN 073-050-170)  
GEOGRAPHIC DESCRIPTION

ALL THAT CERTAIN REAL PROPERTY BEING PORTION OF THE PULGAS RANCHO, SITUATE IN THE TOWN OF WOODSIDE, COUNTY OF SAN MATEO, STATE OF CALIFORNIA, ALSO BEING PORTION OF A LOT 9 IN BLOCK 1 AS SHOWN OF SUBDIVISION MAP FILED IN BOOK 12 OF SUBDIVISION MAPS ON PAGES 54 AND 55 IN THE OFFICE OF THE SAN MATEO COUNTY RECORDER, BEING MORE PARTICULARLY DESCRIBED AS FOLLOWS:

BEGINNING AT A POINT ON A WESTERLY LINE OF THE FAIR OAKS SEWER MAINTENANCE DISTRICT (DISTRICT) BOUNDARY ADOPTED ON AUGUST 7, 1973 BY RESOLUTION **NO.31983**, SAID POINT ALSO BEING MOST WESTERLY POINT OF LANDS OF DIBBLE AS DESCRIBED IN DEED 2010-027521 RECORDED ON 3/11/2012 IN THE OFFICE OF SAN MATEO COUNTY RECORDER

1. THENCE FROM SAID POINT **NORTH 45°39'00" EAST, A DISTANCE OF 130.00 FEET** ALONG THE NORTHERLY LINE OF FAIR OAKS SEWER MAINTENANCE DISTRICT;
2. THENCE **SOUTH 44°21'00" EAST, A DISTANCE OF 159.58 FEET**;
3. THENCE **SOUTH 45°39'00" WEST, A DISTANCE OF 130.00 FEET**; AND
4. THENCE **NORTH 44°21'00" WEST, A DISTANCE OF 159.58 FEET TO THE POINT OF THE BEGINNING (POB)**

CONTAINING AREA OF **20,745.40 SQUARE FEET, 0.48 ACRES** MORE OR LESS.

END OF DESCRIPTION

A PLAT MAP, EXHIBIT "B", IS ATTACHED HERETO AND IS MADE A PART OF HEREOF, FOR REFERENCE ONLY.

THIS DESCRIPTION WAS PREPARED BY ME OR UNDER MY DIRECTION IN CONFORMANCE WITH THE PROFESSIONAL LAND SURVEYORS' ACT.

  
\_\_\_\_\_  
JOHN T. MAY PLS 8570

LICENSE EXPIRES: 03/31/2019

DATE: 11/14/17

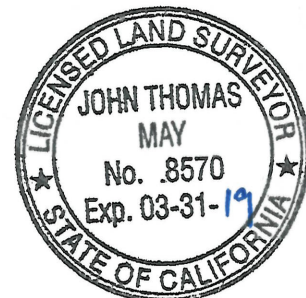

**ANNEXATION OF THE LANDS OF  
DIBBLE TO THE FAIR OAKS SEWER  
MAINTENANCE DISTRICT  
156 BARDET ROAD  
APN 073-050-170**

