



## County of San Mateo

### Contract Amendment Coversheet and Contract Amendment for

#### CONTRACT SUMMARY

<b>Contract No:</b>	<b>Contractor Name:</b>	<b>Amendment No:</b>
R075918 & R080465	Truebeck Construction, Inc.	029

#### THE AGREEMENT HAS CHANGED AS FOLLOWS:

Agreement Amount		
<b>Original Project Budget:</b>	<b>\$13,600,705</b>	
<b>Amendment 1 Amount:</b>	\$1,766,880	
<b>Amendment 4 Amount:</b>	\$74,284	
<b>Amendment 6 Amount:</b>	\$505,527	
<b>Amendment 8 Amount:</b>	\$432,812	
<b>Amendment 10 Amount:</b>	\$304,275	
<b>Amendment 11 Amount:</b>	\$273,802	
<b>Amendment 12 Amount:</b>	\$4,398,000	
<b>Amendment 13 Amount:</b>	\$2,500,148	
<b>Amendment 15 Amount:</b>	\$125,331	
<b>Amendment 19 Amount:</b>	\$69,362,343	
<b>Amendment 20 Amount:</b>	\$88,487,293 (COB3 GMP)	
<b>Negotiated GMP Agreement:</b> *A delta of \$55,940 was discovered. Parties agree to review at a later date	<b>\$181,775,460</b>	
<b>Amendment 21 Amount:</b>	\$2,525,770	
<b>Amendment 22 Amount:</b>	\$856,120.02	
<b>Amendment 23 Amount:</b>	\$192,070	
<b>Amendment 24 Amount:</b>	\$717,000.98	
<b>Amendment 25 Amount:</b>	\$1,288,963	
<b>Amendment 26 Amount:</b>	\$2,679,501	
<b>Amendment 27 Amount:</b>	\$971,096	
<b>Amendment 28 Amount:</b>	\$611,514.00	
<b>Amendment 29 Amount:</b> Campus Infrastructure Improvements	<b>\$195,378</b>	

Current Amount:	Addition or Reduction:	New Total:	
\$ 191,617,495.00	\$195,378.00	\$ 191,812,873.00	
Agreement Term			
Original Start Date:	6/26/2018	Original End Term:	Open

**AMENDMENT 29 TO AGREEMENT R080465  
BETWEEN THE COUNTY OF SAN MATEO AND  
TRUEBECK CONSTRUCTION, INC.**

THIS AMENDMENT TO THE AGREEMENT, entered into this \_\_\_\_ day of February 2025,  
by and between the COUNTY OF SAN MATEO, hereinafter called "County," and Truebeck  
Construction, Inc., hereinafter called "Contractor";

W I T N E S S E T H:

WHEREAS, pursuant to Government Code, Section 31000, County may contract with independent contractors for the furnishing of such services to or for County or any Department thereof; and

WHEREAS, on June 26, 2018, the County entered into that certain agreement with Contractor for the construction of and various improvements to County Office Building 3, as amended (the "Agreement"); and

WHEREAS, the on June 25, 2024, the County Board of Supervisors adopted Resolution 080465, which authorized the execution of an amendment and change orders under the Agreement in connection with among other things, landscape, hardscape, and infrastructure improvements at County Center to create a cohesive campus, providing accessibility infrastructure, and increasing Americans with Disabilities Act (ADA) compliance (the "Campus Infrastructure Improvement Project") for an amount not to exceed of \$6,100,000; and

WHEREAS, although the amendment authorized under Resolution No. 080465 was not executed, the County directed Contractor to proceed with initial project development phase work in connection with the anticipated Campus Infrastructure Improvement Project and Contractor incurred expenses related to carrying out such work; and

WHEREAS, on August 12, 2024, the initial development work indicated that the Campus Infrastructure Improvement Project could not be completed within the authorized amount of \$6,100,000 and would exceed such amount by approximately \$15 million; and

WHEREAS, on August 14, 2024, the County directed Contractor to cease work relating to the Campus Infrastructure Improvement Project; and

WHEREAS, the Parties have agreed that County shall reimburse Contractor for expenses incurred for the Campus Infrastructure Improvement Project in the amount of \$195,378, and

that Contractor agrees to accept such sum and release and forever discharge the County for further liability in connection with the Campus Infrastructure Improvement Project; and

WHEREAS, the Parties desire to amend the Agreement to increase the County's maximum payment amount by \$195,378, to approve associated change orders pertaining to requested efforts related to the Campus Infrastructure Improvement Project, and to make such other amendments as set forth herein.

**NOW, THEREFORE, IT IS HEREBY AGREED BY THE PARTIES HERETO AS FOLLOWS:**

1. The Parties is hereby amended and restated to increase the County's maximum fiscal obligation by \$195,378.00 for a total not to exceed amount of \$191,812,873.00.
  2. The Parties agree that the change order request 5475 pertaining to Campus Infrastructure Engineering Drawings in the amount of \$10,971.00, which is attached hereto as Exhibit A and incorporated by reference as it fully set forth herein, is hereby approved.
  3. The Parties agree that change order request 5177.2 pertaining to RFI 806 – Public Circulation Foundation in the amount of \$15,442.00, which is attached hereto as Exhibit B and incorporated by reference as it fully set forth herein, is hereby approved.
  4. The Parties agree that change order request 5533 pertaining to Truebeck preconstruction expenses and builder risk costs in the amount of \$168,965, which is attached hereto as Exhibit C and incorporated by reference as it fully set forth herein, is hereby approved.
- 10. All other terms and conditions of the Agreement dated 06/26/2018, between the County and Contractor shall remain in full force and effect.**



In witness of and in agreement with this Agreement's terms, the parties, by their duly authorized representatives, affix their respective signatures:

**For Contractor: Truebeck Construction, Inc.**

<div>DocuSigned by:  7B45E330D7A4438...</div>	Apr-15-2025   10:44 PDT	Mark Whiley
Contractor Signature	Date	Contractor Name (please print)

---

**For County:**

COUNTY OF SAN MATEO

By:

President, Board of Supervisors, San Mateo County

Date:

ATTEST:

By:

Clerk of Said Board



**PCCO #5177.2–Truebeck #CE: #5177.2: RAB COR 08  
Public Circulation (Early Work) Signage Footings**

PDP01 COB3 Truebeck 84700-24-R080465

**Owner:**

County Manager's Office  
500 County Center Floor 5  
Redwood City, CA 94063

**Date: January 29, 2025**

**Change Order Title: PDP01 COB3 Truebeck 84700-24-R080465 CE#5177.2:- RAB COR 08**

- Public Circulation (Early Work) Signage Footings

**REF: Cost Proposal Listed**

**DISPOSITION:**

☒ Approved

☐ Rejected

**NARRATIVE:**

x See attached documents

The PDU has reviewed Truebeck Change Order Request #5177.2 and this change order request is approved for full and final amount of **\$15,442.00** for all labor, material, equipment, and incidentals whether direct or indirect to provide the scope described herein.

**POTENTIAL CHANGE ORDER DESCRIPTION: (The Contract Is Changed As Follows)**

**CE #5177.2 - RAB COR 08- Public Circulation (Early Work) Signage Footings**

**Description of Change:**

Per RFI 806, signage is to be added within the COB3 project limits under the Public Circulation package. In order to avoid demo of recently completed hardscape to get concrete footings installed for these future signs, RFI 806 provided direction to build a concrete footing and provided design details.

**Entitlement:**

Added scope to the COB3 project to get future Public Circulation signage infrastructure in place

**Funding:**

Additive change order to GMP

ATTACHMENTS:

#	Cost Code	Description	Type	Amount
1	303-033000 - CAST-IN-PLACE CONCRETE	CE 5177.2-RAB COR 08 - Public Circulation (Early Work) Signage Footings	Subcontract	\$14,082.00
Subtotal:				\$14,082.00
Fee ( ≈ 2.75%):				\$387.00
Construction Contingency (3.00%):				\$422.00
Builder's Risk ( ≈ 3.91%):				\$551.00
Grand Total:				\$15,442.00

Adjustment  
cost:    TBD    ADD    DEDUCT       schedule impact:    YES    NO    TBD

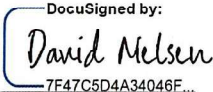
Owner/County    DocuSigned by:  
  
7F47C5D4A34046F...  
(Signature)    David Nielsen

Jan-29-2025 | 12:10 PST  
\_\_\_\_\_  
(Date)



**TRUEBECK CONSTRUCTION** **AMC (11/9/23)** - Our review indicates this request has been presented with fair **PCO #5177.2** and reasonable pricing and AMC takes **NO exceptions as submitted.**

**Prime Contract Potential Change Order #5177.2: CE #5177.2 - RAB COR 08 - Public Circulation (Early Work) Signage Footings**

TO:	County of San Mateo - Project Development Unit 555 County Center, Second Floor Redwood City California, 94063	FROM:	Truebeck Construction 2855 Campus Drive Suite 100 San Mateo California, 94403
PROJECT:	418017.300 - SMC-COB3 Phase 2 555 County Center Redwood City, California 94063	CONTRACT:	1 - SMC-COB3 Phase 2 Prime Contract
PCO NUMBER/REVISION:	5177.2 / 3	CREATED DATE:	11/16 /2023
CREATED BY:	James Shimamoto (Truebeck Construction)	TOTAL AMOUNT:	\$15,442.00
SCHEDULE IMPACT:			

**POTENTIAL CHANGE ORDER DESCRIPTION:** *(The Contract Is Changed As Follows)*

CE #5177.2 - RAB COR 08 - Public Circulation (Early Work) Signage Footings

Description of Change:

Per RFI 806, signage is to be added within the COB3 project limits under the Public Circulation package. In order to avoid demo of recently completed hardscape to get concrete footings installed for these future signs, RFI 806 provided direction to build a concrete footing and provided design details.

Entitlement:

Added scope to the COB3 project to get future Public Circulation signage infrastructure in place

Recommendation and Funding Source:

Additive change order to GMP

**ATTACHMENTS:**

[RFC# 08\\_R1 - RFI #806 Signage Footings.pdf](#)

**AMC (12/17/24)** - Although AMC takes no exception to the merit of this request, as currently submitted, AMC is unable to provide a positive recommendation of acceptance to the County. Please see AMC Comment(s) of below for specific details.

#	Cost Code	Description	Type	Amount
1	303-033000 - CAST-IN-PLACE CONCRETE	CE 5177.2-RAB COR 08 - Public Circulation (Early Work) Signage Footings	Subcontract	\$14,082.00
Subtotal:				\$14,082.00
Fee ( ≈ 2.75%):				\$387.00
Construction Contingency (3.00%):				\$422.00
Builder's Risk ( ≈ 3.91%):				\$551.00
Grand Total:				\$15,442.00

AMC #1 - Wage rates requested from RAB for do align with other compared to, please provide a wage rate breakdowns for each classification seeking compensation.

Wage rates are on last page of document

AMC #2 - Charges for the Backhoe and Off-Haul will need supporting documentation. If backhoe is owned, please provide in CalTrans format, if rented please provide invoice for rental. Off-haul costs will require disposal receipt.

CalTrans backup provided on pg. 5 for the backhoe.  
The off-haul back up is provided on pg 4; Bothman made a mistake and only billed for \$500 for off haul work even though they the costs were higher.

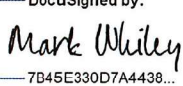
DocuSigned by:  
  
7B45E330D7A4438...

Jan-29-2025 | 12:20 PST

SIGNATURE

DATE

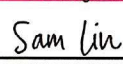
DocuSigned by:  
  
B7F4B372C432...

Jan-29-2025 | 14:25 PST

SIGNATURE

DATE

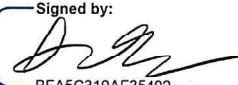
Signed by:  
  
BFA5C319AF35492...

Jan-29-2025 | 13:29 PST

SIGNATURE

DATE

Truebeck Construction Inc.

page 1 of 1

Printed On: 6/10/ 2024 11 :26 AM





www.bothman.com

2690 Scott Boulevard ■ Santa Clara, CA 95050

Tel 408. 279. 2277 ■ Fax 408. 279. 2281

## REQUEST FOR CHANGE

Date: 10/31/2023

RFC # 08

Project: 22-019 San Mateo Office Building 3

ICO#

### Scope of Change:

Additional Labor, Equipment, and Material cost for added signage footings per RFI #806

### Notice of Intent to Proceed:

Information here

### Reference:

T&M

### Adjustment of the Contract Time:

3 Days

### Adjustment of the Contract Sum:

#### Subcontractor(s):

subs name	0.00
subs name	0.00
subs name	0.00
subs name	0.00
Total	0.00
Contractor Mark-up (0%)	0.00

>>>>>>

#### General Contractor:

Material	3,648.95	✓
Labor	7,376.24	✓
Equipment	1,220.00	✓
Subtotal	12,245.19	✓
Contractor Mark-Up 15%	1,836.78	✓
Total	14,081.97	
Subcontractor Total	0.00	
Grand Total	14,082.00	

#### TCI REVIEW COMMENTS:

- (3) footings, probably (2) phases due to one sign being in South courtyard which is not ready yet
- Work includes layout, excavation and offhaul, install gravel, rebar installation, and concrete placement

#### Prepared and Submitted By:

Broc Neely

Senior Project Engineer

Print Name & Title

#### Reviewed and Approved By:

Print Name & Title

Date:

*This change represents full and complete compensation for all presently known direct costs required to perform the work set forth herein, plus overhead and profit specific to the work, as provided in the contract documents. Robert A. Bothman hereby reserves its right to submit a request for equitable adjustments for all cumulative impacts, including time extensions and costs resulting from this change or others on unchanged contract work. We will proceed with the work of this proposal when authorized in accordance with the contract documents.*



**Graniterock**

P.O. Box 50001  
Watsonville, CA 95077-5001  
(831) 768-2000

Customer: 13511

Robert A Bothman Inc \*Job# Req\*  
2690 Scott Boulevard  
Santa Clara, CA 95050

Invoice No: **2130824**  
Invoice Date: 11/30/2023  
Job No: 22-019  
Order No: 2113836  
Job PO No: 22-019  
Job Name: County Center- 500 County Center Redwood C  
Job Street: 500 County Center Redwood City  
Job City: Redwood City

## Other

Product	Truck	Qty	Product Price	Amount	Price	Freight Amount	Additional Charges	Tax Amount	Total
Date: 11/17/2023	Ticket: 900015893	Location: Graniterock Transportation					Other Ticket #: T477299		
PLF	39136	1.00 Load			755.00	755.00	37.75	9.88%	792.7
Partial Load Freight									
PWT	39136	1.00 EA	25.00	25.00				9.88%	25.0
Prevailing Wage Administrative Fee 710									
<b>Totals for Ticket 900015893</b>				<b>25.00</b>		<b>755.00</b>	<b>37.75</b>	<b>0.00</b>	<b>817.7</b>

Offhaul costs - only \$500 charge

### Summary of Additional Charges

Fuel Surcharge 37.75  
Prevailing Wage Administrative Fee

	Product	Freight	Additional	Tax	Tot
Invoice Totals		<b>4,504.00</b>	<b>755.00</b>	<b>172.75</b>	<b>442.35</b>
					<b>5,874.7</b>

For questions, or additional info, contact Customer Service at (831) 768-2120 or CustomerServiceAll@graniterock.com

### SHORT PAY POLICY:

Our philosophy of total customer satisfaction can be summarized with the following statement:  
If you are not satisfied for any reason . . . don't pay us for it

That means that if any part of this invoice is incorrect or if you were unhappy with the products or services received from this transaction, let us know right now.  
Simply scratch out the related line item, write a brief note about the problem, and return a copy of this invoice along with your check for the remaining balance.  
Someone will contact you immediately to resolve the problem.

Please Make Checks Payable to:

Granite Rock Company  
P.O. Box 50001  
Watsonville, CA 95077-5001

Customer No: 13511

Invoice No: 2130824

Invoice Date: 11/30/2023

Sold To: Robert A Bothman Inc \*Job# Req\*  
2690 Scott Boulevard  
Santa Clara, CA 95050

Total Due by 12/25/2023 \$5,874.10

Deduct Discount Amount if Received by 12/15/2023 \$29.67

Payment Enclosed

If haul charges are indicated separately above, title passage of material is at the plant, with delivery provided by Graniterock for customer's account.



Go Green - Sign up for paperless e-Delivery of your invoices. Contact Customer Service at (831) 768-2120 or CustomerServiceAll@graniterock.com

# **KOMATSU**

## [ KOMA ]

<u>Model</u>	<u>Code</u>	<u>Rate</u>
D 53S-16	7878	\$81.42
D 53S-17	7878A	\$94.81
D 55S-2	7900	\$84.92
D 55S-3	7978	\$84.92
D 57S-1	8000	\$110.78
D 65S-6	8017	\$111.27
D 66S-1	8020	\$146.73
D 75S-2	8056	\$120.69
D 75S-3	8060	\$148.39
D 75S-5	8061	\$204.93
D 155S-1	8080	\$284.64

# **LOADERS, RUBBER TIRE**

## [ LDRRT ]

**DELAY FACTOR = 0.10**

**OVERTIME FACTOR = 0.90**

Includes all attachments and accessories. Clam-action buckets, 4WD and backhoes are excluded unless otherwise noted.

# **ALLIS-CHALMERS**

## [ A-C ]

<u>Model</u>	<u>Code</u>	<u>Rate</u>
710C	0747	\$48.00
714B	0750	\$47.03
714C w/ backhoe	0752	\$49.72
715B w/ backhoe	0765	\$49.08
715C w/ backhoe	0767	\$49.99

# **CASE**

## [ CASE ]

<u>Model</u>	<u>Code</u>	<u>Rate</u>
W-11	1365	\$44.05
W-11B	1368	\$53.97
W-18	1444	\$75.86
W-18 9213140 serial	1450	\$79.66
W-18B	1460	\$85.81
W-20	1472	\$79.78
W-20B	1480	\$80.62
W-20C	1482	\$86.65
W-30	1565	\$119.09
480B	1636	\$38.86
480B w/ backhoe	1640	\$40.22
480C	1650	\$49.98
480C w/ backhoe	1660	\$51.63
480D	1662	\$55.70
480D w/ backhoe	1664	\$57.76
480E w/ backhoe	1666	\$47.23
480E LL	1667	\$45.94
480F w/ backhoe	1668	\$48.61
480F LL	1669	\$46.74
480LL	1677	\$55.75
570L XT 4WD	1690	\$53.34

570N XT	1700	\$66.80
580B w/ backhoe	1705	\$50.59
580C	1710	\$40.08
580C w/ backhoe	1715	\$42.09
580D	1717	\$41.51
580D w/ backhoe	1720	\$44.16
580 Super D	1725	\$45.31
580 Super D w/ backhoe	1727	\$48.01
580 Super E	1731	\$46.77
580 Super E w/ backhoe	1735	\$49.68
580K w/ backhoe	1739	\$49.99
580K 4WD w/ backhoe	1740	\$51.14
580 Super K w/ backhoe	1742	\$55.31
580L w/ backhoe	1743	\$55.59
580 Super L 4WD w/ backhoe	1744	\$64.38
590 Turbo w/ backhoe	1745	\$67.67
590 Super L 4WD w/ backhoe	1746	\$70.25
621	1750	\$91.31
721	1752	\$110.78
821	1754	\$135.32
680E w/ backhoe	1840	\$63.34
680G w/ backhoe	1850	\$62.02
680H w/ backhoe	1852	\$65.07
680K w/ backhoe	1854	\$71.44
680L w/ backhoe	1856	\$72.22
680L 4WD w/ backhoe	1857	\$73.07
780 w/ backhoe	1864	\$82.15
780B w/ backhoe	1866	\$87.34
780C w/ backhoe	1867	\$88.75
780D w/ backhoe	1868	\$89.57
780D 4WD w/ backhoe	1869	\$91.05

# **CATERPILLAR**

## [ CAT ]

<u>Model</u>	<u>Code</u>	<u>Rate</u>
415F2	1850F2	\$63.21
416 w/ backhoe	1860	\$49.81
416 Series II w/ backhoe	1860A	\$50.06
416B 4WD w/ extend-a-hoe	1861A	\$61.30
416C 4WD w/ backhoe	1861C	\$63.26
416D w/ backhoe	1861D	\$58.10
416D 4WD w/ backhoe	1861D4	\$59.27
420D w/ backhoe	1861M	\$65.29
420D 4WD w/ backhoe	1861M4	\$66.46
420E	1861N	\$77.52
420F2	1861N2	\$91.86
426 w/ backhoe	1862	\$56.29
426 Series II w/ backhoe	1862A	\$56.54
426C w/ backhoe	1862C	\$70.06
426C 4WD w/ backhoe	1862C4	\$71.57
428 w/ backhoe	1864	\$56.26
428 Series II w/ backhoe	1864A	\$56.52





Customer: 13511

Robert A Bothman Inc \*Job# Req\*  
2690 Scott Boulevard  
Santa Clara, CA 95050

Invoice No: 2128615  
Invoice Date: 11/18/2023  
Job No: 22-019  
Order No: 2113836  
Job PO No: 22-019  
Job Name: County Center- 500 County Center Redwood C  
Job Street: 500 County Center Redwood City  
Job City: Redwood City

Aggregate and Asphalt

Ticket	Date	Truck	Qty	Product	Price	Amount	Price	Freight	Additional	Tax	Total
Location								Amount	Charges	Amount	
Product: 217 - Class 2 Permeable Material											
3598974	11/17/2023	39136	11.73	Tons	40.00	469.20			11.17	9.88%	527.69
A. R. Wilson Quarry											
Totals for Product 217 on 11/17/2023			11.73			469.20		0.00	11.17	47.32	527.69

\$527.69 / 12 TN = \$44/TN  
Very close to RAB charge

Summary of Additional Charges	
Environmental Recovery Fee	10.00
San Benito County Mining Tax	1.17

Product	Freight	Additional	Tax	Tot
Invoice Totals	469.20	0.00	11.17	527.69

For questions, or additional info, contact Customer Service at (831) 768-2120 or CustomerServiceAll@graniterock.com

SHORT PAY POLICY:

Our philosophy of total customer satisfaction can be summarized with the following statement:  
If you are not satisfied for any reason . . . don't pay us for it  
That means that if any part of this invoice is incorrect or if you were unhappy with the products or services received from this transaction, let us know right now.  
Simply scratch out the related line item, write a brief note about the problem, and return a copy of this invoice along with your check for the remaining balance.  
Someone will contact you immediately to resolve the problem.

Please Make Checks Payable to:

Granite Rock Company  
P.O. Box 50001  
Watsonville, CA 95077-5001

Customer No: 13511  
Invoice No: 2128615  
Invoice Date: 11/18/2023

Sold To: Robert A Bothman Inc \*Job# Req\*  
2690 Scott Boulevard  
Santa Clara, CA 95050

Total Due by 12/25/2023 \$527.69  
Deduct Discount Amount if Received by 12/10/2023 \$3.22

Payment Enclosed

If haul charges are indicated separately above, title passage of material is at the plant, with delivery provided by Graniterock for customer's account.



ROBERT A.

**BOTHMAN**  
**CONSTRUCTION** 

www.bothman.com

2690 Scott Boulevard ■ Santa Clara, CA 95050

Tel 408.279.2277 ■ Fax 408.279.2281

Project Name: 22-019 San Mateo Office Building 3

Date 10/31/2023

Description: Additional Labor, Equipment, and Material cost for added signage footings per RFI #806

RFC# 8.0

Reference CE 5177.32

Labor time and material rates effective through June 30, 2022

LABOR	Hours	S.T. Rate	Subtotal	Hours	O.T. Rate	Subtotal	Hours	D.T. Rate	Subtotal	Extended Amounts
Carpenter Foreman		\$144.11			\$184.86			\$225.62		
Carpenter		\$136.70			\$173.75			\$210.80		
Cement Mason Foreman	8.0	\$111.38	\$891.08		\$143.54			\$175.69		\$891.08
Cement Mason	24.0	\$104.86	\$2,516.67		\$133.75			\$162.64		\$2,516.67
Laborer Foreman		\$95.93			\$122.54			\$149.15		
Laborer	32.0	\$93.08	\$2,978.57		\$118.27			\$143.46		\$2,978.57
Operator Foreman	8.0	\$123.74	\$989.93		\$161.46			\$199.19		\$989.93
Operator		\$118.46			\$153.54			\$188.62		
Site Superintendent		\$149.12			\$192.38			\$235.64		
General Superintendent		\$153.61			\$205.99			\$258.36		
Project Engineer		\$99.06			\$137.77			\$176.48		
Project Manager		\$167.25			\$233.29			\$299.32		
<b>A - LABOR TOTAL</b>			<b>\$7,376.24</b>							<b>\$ 7,376.24</b>

EQUIPMENT	Units/ Hours	Unit Cost	Extended Amounts
Backhoe	8.0	\$ 90.00	\$720.00
Off-Haul	1.0	\$500.00	\$500.00
<b>B - EQUIPMENT TOTAL</b>			<b>\$1,220.00</b>

MATERIALS*	No. Units	Unit Cost	Extended Amounts
Concrete	6	\$175.00	\$1,050.00
Drainage Gravel	8	\$55.00	\$440.00
Rebar	1	\$1,350.00	\$1,350.00
Misc. Material	1	\$500.00	\$500.00
<b>C - MATERIAL TOTAL *</b>			<b>\$3,648.95</b>

\*CA Sales Tax = 9.25%

Misc material - stakes, lumber, plywood, nails, screws, etc. are stocked items and not ordered specifically for each scope but rather taken out of Bothman stock at their yard

SUBCONTRACTOR	Contract Amount	Extended Amounts
<b>D - SUB-CONTRACT TOTAL</b>		

ADDED PERCENTAGE (SEE SPECIFICATIONS)	BOX	Mark-Up %	Totals With Mark-Up
Total Cost of Labor	A	15%	\$8,482.68
Total Cost of Equipment	B	15%	\$1,403.00
Total Cost of Material	C	15%	\$4,196.29
Total Cost of Subcontractors	D	5.0%	
Bond Premium	E		
<b>TOTAL OF THIS REPORT</b>			<b>\$14,082.00</b>



Customer: 13511

Robert A Bothman Inc \*Job# Req\*  
2690 Scott Boulevard  
Santa Clara, CA 95050

Invoice No: 2138530  
Invoice Date: 01/20/2024  
Job No: 22-019  
Order No: 2113836  
Job PO No: 22-019  
Job Name: County Center- 500 County Center Redwood C  
Job Street: 500 County Center Redwood City  
Job City: Redwood City

Concrete

Product			Qty	Product Price	Amount	Price	Freight Amount	Additional Charges	Tax Amount	Total	
Date: 01/15/2024		Ticket: 119840		Location: Peninsula Concrete							
67T549			9.00	Cu Yd	150.00	1,350.00		45.00	9.88%	133.31	1,528.31
6 SACK 15% FA 35% SLAG 4000 PSI											
120600			1,633.50	OZ	0.20	326.70			9.88%	32.26	358.96
Daraset 400							\$1,932.32 / 9 = \$214.70				
000FSC			1.00	EA	6.00	6.00		9.88%	0.59	6.59	
Fuel Surcharge- Concrete											
00ERFC			1.00	EA	35.00	35.00		9.88%	3.46	38.46	
Environmental Recovery Fee Concrete											
Totals for Ticket 119840						1,717.70	0.00	45.00	169.62	1,932.32	
Date: 01/15/2024		Ticket: 119841		Location: Peninsula Concrete							
67T549			9.00	Cu Yd	150.00	1,350.00		45.00	9.88%	133.31	1,528.31
6 SACK 15% FA 35% SLAG 4000 PSI											
120600			1,633.50	OZ	0.20	326.70			9.88%	32.26	358.96
Daraset 400											
000FSC			1.00	EA	6.00	6.00		9.88%	0.59	6.59	
Fuel Surcharge- Concrete											
00ERFC			1.00	EA	35.00	35.00		9.88%	3.46	38.46	
Environmental Recovery Fee Concrete											
Totals for Ticket 119841						1,717.70	0.00	45.00	169.62	1,932.32	
Date: 01/15/2024		Ticket: 119844		Location: Peninsula Concrete							
67T549			9.00	Cu Yd	150.00	1,350.00		45.00	9.88%	133.31	1,528.31
6 SACK 15% FA 35% SLAG 4000 PSI											
120600			1,633.50	OZ	0.20	326.70			9.88%	32.26	358.96
Daraset 400											
000FSC			1.00	EA	6.00	6.00		9.88%	0.59	6.59	
Fuel Surcharge- Concrete											
00ERFC			1.00	EA	35.00	35.00		9.88%	3.46	38.46	
Environmental Recovery Fee Concrete											
Totals for Ticket 119844						1,717.70	0.00	45.00	169.62	1,932.32	
Date: 01/15/2024		Ticket: 119845		Location: Peninsula Concrete							
67T549			9.00	Cu Yd	150.00	1,350.00		45.00	9.88%	133.31	1,528.31
6 SACK 15% FA 35% SLAG 4000 PSI											
120600			1,633.50	OZ	0.20	326.70			9.88%	32.26	358.96
Daraset 400											

\$1,932.32 / 9 = \$214.70







Quote#: 0049314

45055 Fremont Blvd. - Fremont, CA 94538

TEL#: 800-347-7141 - FAX 866-333-2FAX

# Quotation

COMPANY: BOTHMAN ROBT. A. INC.

CONTACT: BOTHMAN, DYLAN

JOB NAME: SAN MATEO OFFICE BUILDING 3

QUOTE DATE: October 17, 2023

PRELIE INFORMATION REQUIRED PRIOR TO FIRST DELIVERY

THIS QUOTATION WILL EXPIRE ON November 22, 2023

**FOR REBAR SOURCING PLEASE SEE IMPORTANT READ SIGN SECTION**

METHOD OF PAYMENT	COUNTY TAX	F.O.B.	ESTIMATE REF.	SALESPERSON
NET 30 DAYS	9.625%	DELIVERED	22-RD322	Tracy, Patrick

QTY	UOM	ITEM	DESCRIPTION	UNIT PRICE	TOTAL
5	Ftgs	OFFSITE	Signage concrete footings	\$1,350	\$1,350



## SW Signage Clarification

<b>Project:</b>	418017.300 - SMC-COB3 Phase 2 555 County Center Redwood City, California 94063		
<b>TO:</b>	Matthew Wasylciw (SOM) Francesca Oliveira (SOM) One Maritime Plaza San Francisco, 94111 Doug Zuuring (Telamon Engrg Consultants Inc) 855 Folsom St # 142 San Francisco, California 94107 Doug Jones (CMG Landscape Architecture) Bernadette Alvarez (SOM) Elissa Gee (SOM)	<b>FROM:</b>	Jack Deasy (Truebeck Construction) 2855 Campus Drive Suite 100 San Mateo, California 94403
<b>DATE INITIATED:</b>	10/25/ 2023		
<b>LOCATION:</b>		<b>DUE DATE:</b>	11/01/2023
<b>COST IMPACT:</b>	TBD	<b>SCHEDULE IMPACT:</b>	TBD
<b>DRAWING NUMBER:</b>		<b>SPEC SECTION:</b>	03 3010 - Site Cast-in-Place Concrete
<b>RECEIVED FROM:</b>			
<b>COPIES TO:</b> Randall Barbour (Truebeck Construction), Kirk Bennett (Truebeck Construction), Rob Bolli (Truebeck Construction), Daniel Bonebrake (Truebeck Construction), Steve Calloway (Truebeck Construction), Jack Deasy (Truebeck Construction), Marco Innocenti (Truebeck Construction), Joel Jaquez (Truebeck Construction), Jimmy Johnston (Truebeck Construction), Mariana Lopez-Roa (Truebeck Construction), Curtis McAdams (Truebeck Construction), Kyle Merker (Truebeck Construction), Jose Romero (Truebeck Construction), Dan Sazer-Krebbbers (Truebeck Construction), James Shimamoto (Truebeck Construction), Jack Stryker (Truebeck Construction), Chris Verrips (Truebeck Construction), Mark Whiley (Truebeck Construction)			

### Question from Jack Deasy (Truebeck Construction)

Please provide requested information as shown on attached mark up regarding electrical and footing needs for the future signage that is part of the Public Circulation scope

**Attachments:**  
[418017.300-SMC-COB3\\_Phase\\_2-SW\\_Signage\\_Clarification-2023-10-26.pdf](#)

**Official Response:** Elissa Gee (SOM) responded on Monday, October 30th, 2023 at 6:35PM PDT  
SOM Response:

Per the County Center Public Circulation Drawings, only sign locations E04.01 and E03.01 will require data and electrical power connections. Per Owner direction, only electrical power will be needed for sign location E01.01 for exterior lighting. Therefore, 3 signs total will require power. Out of those 3, 2 will need data connections. Refer to Technology PC.T1.00 and PC.T1.01, and Electrical Drawing E1.0.

For footing placements for 3 sign locations within the COB3 building area within hardscape (as discussed 10.27.2023) for coordination, see attached location plan with locations dimensioned from guidelines as requested. Final location of all signs and lights to comply with documented alignments per sheet GR2.01.

Provide CCPC graphic signage footings per attached SSK-035 Details 3, 4 & 5 / S0.50 (file: 20231030 - COB3 - SSK\_035 RFI\_0806 S0.50.pdf).

**TECI Response:**  
2023-10-30, TECI: To finalize sign E01.01 location, Contractor to confirm that the existing push button, pole and traffic signal are being removed and relocated as noted in Encroachment Permit Hexagon drawing E-1, project note 3 and Pole location. All sign locations shall have existing utilities potholed or located to verify depth and horizontal location and information sent to design team for review.

**Attachments:**  
[RFI 806-SW\\_Signage\\_Clarification-2023-10-30\\_SOM-TECI Response.pdf](#)



**Official Response: Elissa Gee (SOM)** responded on Thursday, October 26th, 2023 at 6:11PM PDT

SOM Response: Per the County Center Public Circulation Drawings, only sign locations E04.01 and E03.01 will require data and electrical power connections. Per Owner direction, only electrical power will be needed for sign location E01.01 for exterior lighting.

Therefore, 3 signs total will require power. Out of those 3, 2 will need data connections. Refer to Technology PC.T1.00 and PC.T1.01, and Electrical Drawing E1.0

Footing designs and final placement will be forthcoming following coordination meeting and structural input. Please leave RFI open for further information.

**Attachments:**

## All Replies:

### Response from Elissa Gee (SOM) at 06:35 PM on 10/30/2023

SOM Response:

Per the County Center Public Circulation Drawings, only sign locations E04.01 and E03.01 will require data and electrical power connections. Per Owner direction, only electrical power will be needed for sign location E01.01 for exterior lighting. Therefore, 3 signs total will require power. Out of those 3, 2 will need data connections. Refer to Technology PC.T1.00 and PC.T1.01, and Electrical Drawing E1.0.

For footing placements for 3 sign locations within the COB3 building area within hardscape (as discussed 10.27.2023) for coordination, see attached location plan with locations dimensioned from guidelines as requested. Final location of all signs and lights to comply with documented alignments per sheet GR2.01.

Provide CCPC graphic signage footings per attached SSK-035 Details 3, 4 & 5 / S0.50 (file: 20231030 - COB3 - SSK\_035 RFI\_0806 S0.50.pdf).

TECI Response:

2023-10-30, TECI: To finalize sign E01.01 location, Contractor to confirm that the existing push button, pole and traffic signal are being removed and relocated as noted in Encroachment Permit Hexagon drawing E-1, project note 3 and Pole location. All sign locations shall have existing utilities potholed or located to verify depth and horizontal location and information sent to design team for review.

**Attachments:**

[RFI 806-SW\\_Signage\\_Clarification-2023-10-30\\_SOM-TECI Response.pdf](#)

### Response from Elissa Gee (SOM) at 06:11 PM on 10/26/2023

SOM Response: Per the County Center Public Circulation Drawings, only sign locations E04.01 and E03.01 will require data and electrical power connections. Per Owner direction, only electrical power will be needed for sign location E01.01 for exterior lighting.

Therefore, 3 signs total will require power. Out of those 3, 2 will need data connections. Refer to Technology PC.T1.00 and PC.T1.01, and Electrical Drawing E1.0

Footing designs and final placement will be forthcoming following coordination meeting and structural input. Please leave RFI open for further information.

**Attachments:**

BY

DATE

COPIES TO





## SW Signage Clarification

<b>Project:</b>	418017.300 - SMC-COB3 Phase 2 555 County Center Redwood City, California 94063		
<b>TO:</b>	Matthew Wasylciw (SOM) Francesca Oliveira (SOM) One Maritime Plaza San Francisco, 94111 Elissa Gee (SOM) Doug Zuuring (Telamon Engrg Consultants Inc) 855 Folsom St # 142 San Francisco, California 94107 Doug Jones (CMG Landscape Architecture) Bernadette Alvarez (SOM)	<b>FROM:</b>	Jack Deasy (Truebeck Construction) 2855 Campus Drive Suite 100 San Mateo, California 94403
<b>DATE INITIATED:</b>	10/25/2023		
<b>LOCATION:</b>		<b>DUE DATE:</b>	10/30/2023
<b>COST IMPACT:</b>	TBD	<b>SCHEDULE IMPACT:</b>	TBD
<b>DRAWING NUMBER:</b>		<b>SPEC SECTION:</b>	03 3010 - Site Cast-in-Place Concrete
<b>RECEIVED FROM:</b>			
<b>COPIES TO:</b> Randall Barbour (Truebeck Construction), Kirk Bennett (Truebeck Construction), Rob Bolli (Truebeck Construction), Daniel Bonebrake (Truebeck Construction), Steve Calloway (Truebeck Construction), Jack Deasy (Truebeck Construction), Marco Innocenti (Truebeck Construction), Joel Jaquez (Truebeck Construction), Jimmy Johnston (Truebeck Construction), Mariana Lopez-Roa (Truebeck Construction), Curtis McAdams (Truebeck Construction), Kyle Merker (Truebeck Construction), Jose Romero (Truebeck Construction), Dan Sazer-Krebbers (Truebeck Construction), James Shimamoto (Truebeck Construction), Jack Stryker (Truebeck Construction), Chris Verrips (Truebeck Construction), Mark Whiley (Truebeck Construction)			

### Question from Jack Deasy (Truebeck Construction)

Please provide requested information as shown on attached mark up regarding electrical and footing needs for the future signage that is part of the Public Circulation scope

Awaiting an Official Response

### All Replies:

#### SOM Response:

Per the County Center Public Circulation Drawings, only sign locations E04.01 and E03.01 will require data and electrical power connections. Per Owner direction, only electrical power will be needed for sign location E01.01 for exterior lighting. Therefore, 3 signs total will require power. Out of those 3, 2 will need data connections. Refer to Technology PC.T1.00 and PC.T1.01, and Electrical Drawing E1.0.

For footing placements for 3 sign locations within the COB3 building area within hardscape (as discussed 10.27.2023) for coordination, see attached location plan with locations dimensioned from guidelines as requested. Final location of all signs and lights to comply with documented alignments per sheet GR2.01.

Provide CCPC graphic signage footings per attached SSK-035 Details 3, 4 & 5 / S0.50 (file: 20231030 - COB3 - SSK\_035 RFI\_0806 S0.50.pdf).

#### TECI Response:

2023-10-30, TECI: To finalize sign E01.01 location, Contractor to confirm that the existing push button, pole and traffic signal are being removed and relocated as noted in Encroachment Permit Hexagon drawing E-1, project note 3 and Pole location. All sign locations shall have existing utilities potholed or located to verify depth and horizontal location and information sent to design team for review.

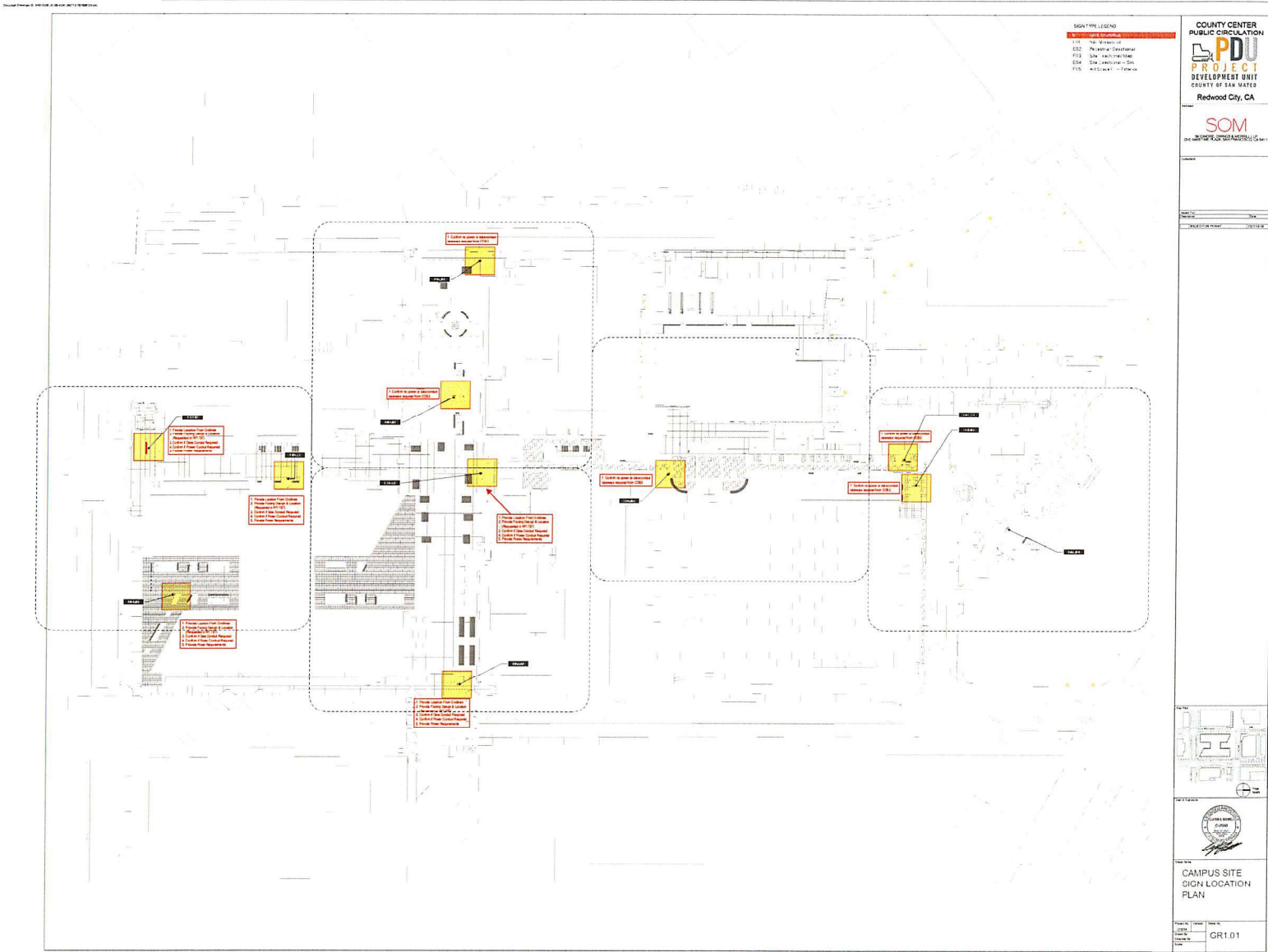

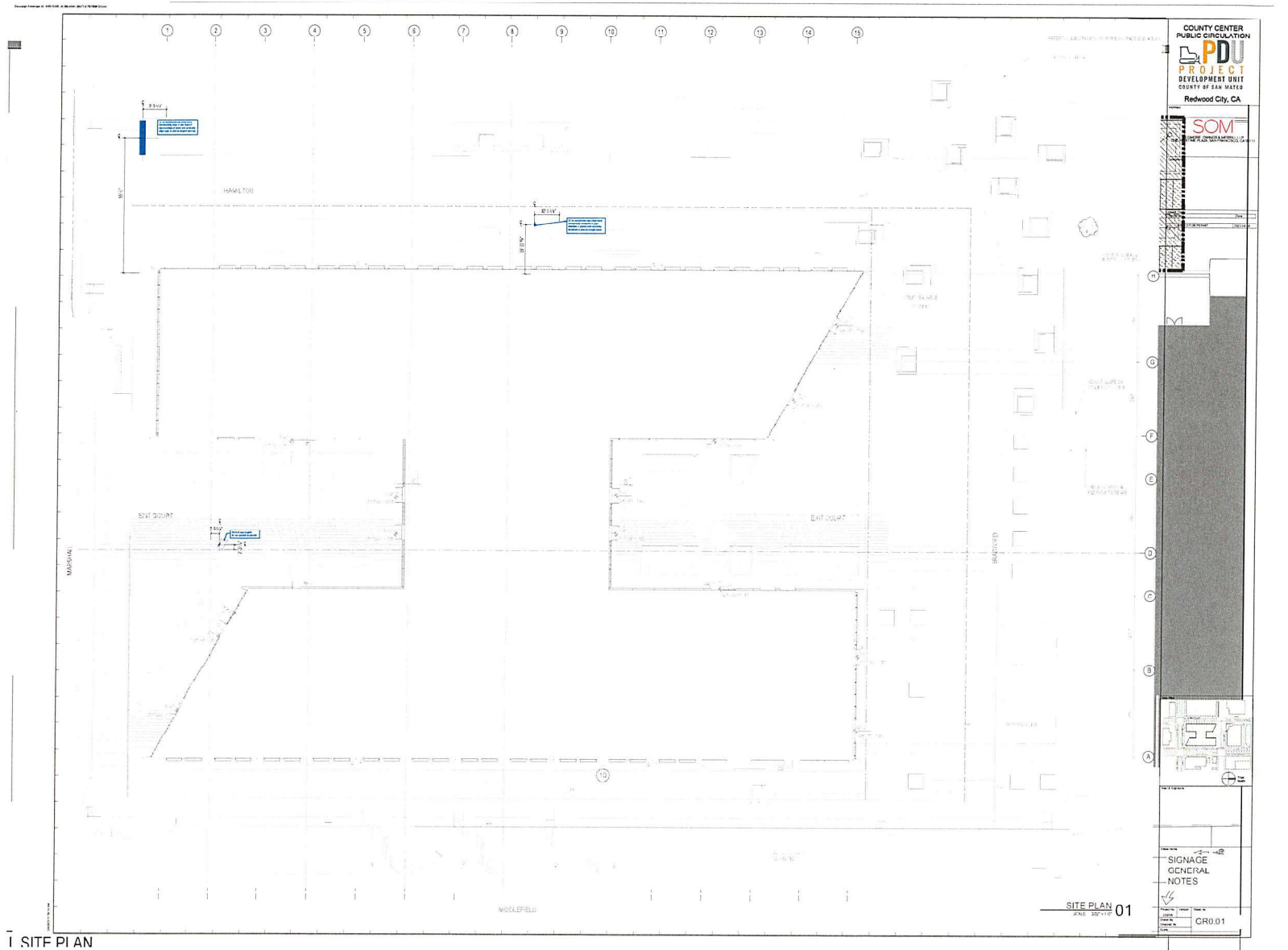

1 SITE PLAN



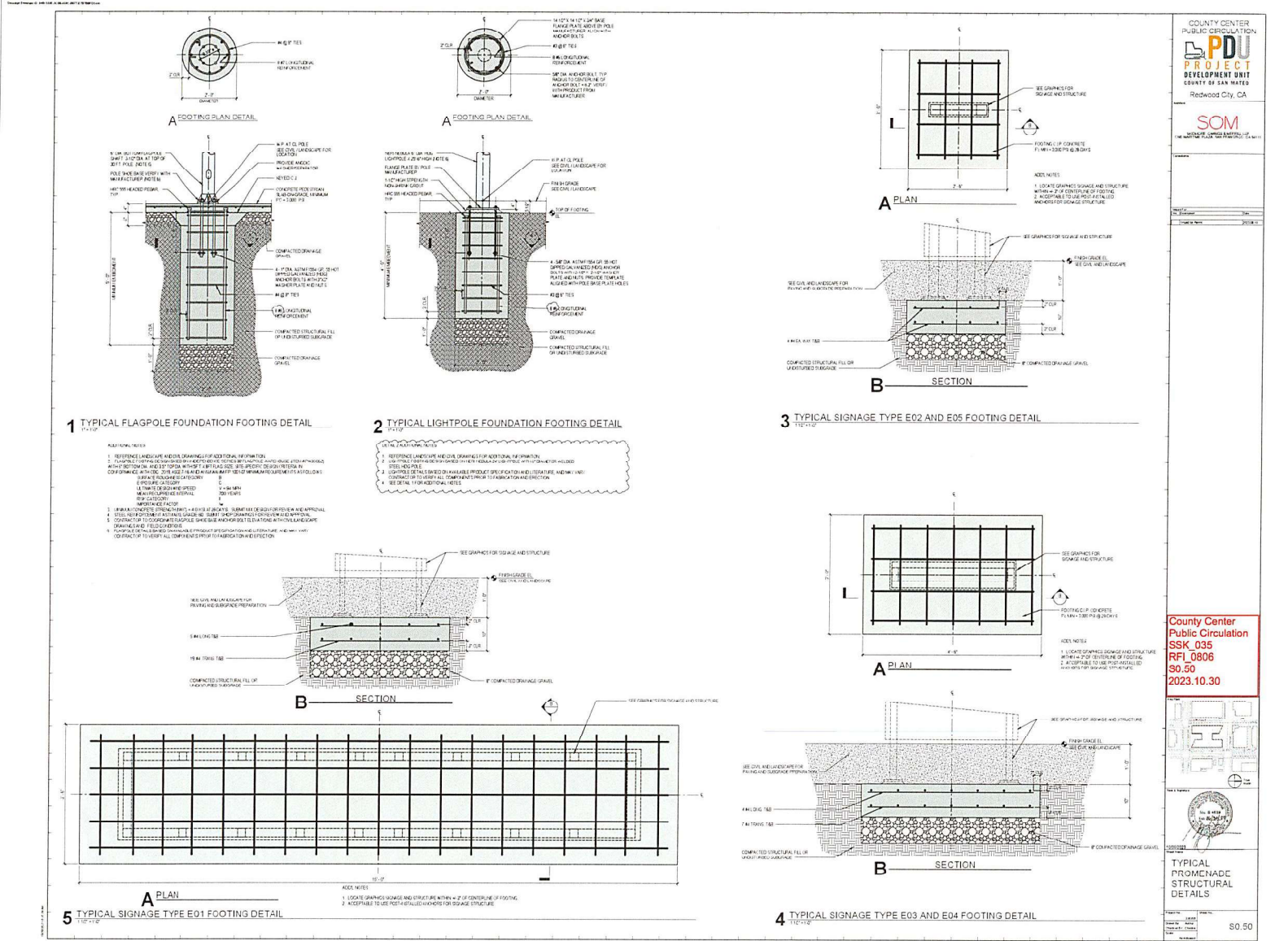

COUNTY CENTER  
PUBLIC CIRCULATION  
PROJECT  
DEVELOPMENT UNIT  
COUNTY OF SAN MATEO  
Redwood City, CA

**SOM**  
STRUCTURAL OFFICE OF MATTHEW  
1000 CALIFORNIA STREET, SUITE 100  
REDWOOD CITY, CA 94063  
(650) 343-1000  
www.sominc.com

County Center  
Public Circulation  
SSK\_035  
RFI\_0806  
\$0.50  
2023.10.30

TYPICAL  
PROMENADE  
STRUCTURAL  
DETAILS

Project No.	SSK_035
Revision No.	01
Revision Date	10/30/23
Revision Description	ISSUED FOR PERMIT

\$0.50

Based on T&M Labor Rates Through June 30, 2024													
STRAIGHT TIME													
	CEMENT MASON	CEMENT MASON Foreman	LABORER	LABORER FOREMAN	OPERATOR BACKHOE GROUP 4	OPERATOR Foreman	CARPENTER		SALARIED SUPERINTENDENT	General Superintendent	PROJECT MANAGER	ASST. PROJECT MANAGER	
							AREA 1	Carpenter foreman					
Basic Hourly	\$ 50.75	\$ 56.48	\$ 44.25	\$ 46.75	\$ 61.63	\$ 66.27	\$ 65.09	\$ 71.60	\$ 76.00	\$ 92.00	\$ 116.00	\$ 68.00	
Fringe Benefits													
Health & Welfare	\$ 8.85	\$ 8.85	\$ 9.30	\$ 9.30	\$ 13.38	\$ 13.38	\$ 11.85	\$ 11.85	\$ 11.85	\$ 13.38	\$ 5.57	\$ 5.00	
Pension	\$ 11.61	\$ 11.61	\$ 8.96	\$ 8.96	\$ 10.78	\$ 10.78	\$ 10.95	\$ 10.95	\$ 10.95	\$ 10.78	\$ 7.48	\$ 4.62	
Vacation & Holiday	\$ 6.15	\$ 6.15	\$ 3.05	\$ 3.05	\$ 5.37	\$ 5.37	\$ 5.16	\$ 5.16	\$ 5.16	\$ 5.37	\$ 6.65	\$ 3.22	
Training	\$ 0.60	\$ 0.60	\$ 0.50	\$ 0.50	\$ 1.12	\$ 1.12	\$ 1.08	\$ 1.08	\$ 1.08	\$ 1.12	\$ -	\$ -	
Other Payment	\$ 0.10	\$ 0.10	\$ 4.70	\$ 4.70	\$ 1.28	\$ 1.28	\$ 2.74	\$ 2.74	\$ 2.74	\$ 1.28	\$ 0.21	\$ 0.15	
Fringe Benefits Subtotal	\$ 27.31	\$ 27.31	\$ 26.51	\$ 26.51	\$ 31.93	\$ 31.93	\$ 31.78	\$ 31.78	\$ 31.78	\$ 31.93	\$ 19.91	\$ 12.99	
P/R TAXES & INSURANCE													
% SS	6.20%	\$ 4.84	\$ 5.19	\$ 4.39	\$ 4.54	\$ 5.80	\$ 6.09	\$ 6.01	\$ 6.41	\$ 6.68	\$ 7.68	\$ 8.43	\$ 5.02
% Medicare	1.45%	\$ 1.13	\$ 1.21	\$ 1.03	\$ 1.06	\$ 1.36	\$ 1.42	\$ 1.40	\$ 1.50	\$ 1.56	\$ 1.80	\$ 1.97	\$ 1.17
% SUI	6.20%	\$ 4.84	\$ 5.19	\$ 4.39	\$ 4.54	\$ 5.80	\$ 6.09	\$ 6.01	\$ 6.41	\$ 6.68	\$ 7.68	\$ 8.43	\$ 5.02
FUTA		\$ 0.42	\$ 0.42	\$ 0.42	\$ 0.42	\$ 0.42	\$ 0.42	\$ 0.42	\$ 0.42	\$ 0.42	\$ 0.42	\$ 0.42	\$ 0.42
WC Insurance		\$ 15.57	\$ 15.57	\$ 12.10	\$ 12.10	\$ 11.52	\$ 11.52	\$ 25.99	\$ 25.99	\$ 25.99	\$ 12.10	\$ 12.10	\$ 6.43
Taxes and Insurance Subtotal	\$ 26.80	\$ 27.59	\$ 22.32	\$ 22.67	\$ 24.90	\$ 25.54	\$ 39.83	\$ 40.73	\$ 41.34	\$ 29.68	\$ 31.34	\$ 18.07	
Burden Subtotal	\$ 54.11	\$ 54.90	\$ 48.83	\$ 49.18	\$ 56.83	\$ 57.47	\$ 71.61	\$ 72.51	\$ 73.12	\$ 61.61	\$ 51.25	\$ 31.06	
Total Hourly Rate	\$ 104.86	\$ 111.38	\$ 93.08	\$ 95.93	\$ 118.46	\$ 123.74	\$ 136.70	\$ 144.11	\$ 149.12	\$ 153.61	\$ 167.25	\$ 99.06	



**PCCO #5533 –Truebeck CE #5533: Promenade Cancellation**

PDP01 COB3 Truebeck 84700-24-R080465

**Owner:**

County Manager's Office  
500 County Center Floor 5  
Redwood City, CA 94063

**Date: January 28, 2025**

**Change Order Title: PDP01 COB3 Truebeck 84700-24-R080465 CE #5533: Promenade Cancellation**

**REF: Cost Proposal Listed**

**DISPOSITION:**

☒ Approved

☐ Rejected

**NARRATIVE:**

x See attached documents

The PDU has reviewed Truebeck Change Order Request #5533 and this change order request is approved for full and final amount of **\$168,965.00** for all labor, material, equipment, and incidentals whether direct or indirect to provide the scope described herein.

**POTENTIAL CHANGE ORDER DESCRIPTION: (The Contract Is Changed As Follows)**

**CE #5533 - Promenade Cancellation**

**Description of Change:**

The County directed Truebeck to prepare a GMP for a new project called the 'Promenade' for improvements across the site including, but not limited to, new walkways, paving, signage, lighting, landscaping, and civil improvements. This process began in January 2024. Between January and June of 2024, Truebeck provided budgeting support, constructability review, and site investigations which resulted in a GMP. This pricing package was planned as a change order the Truebeck's Master Agreement and COB3 work. The 6th revision of the GMP was published to the County on 6/17/2024 for approval by the Board of Supervisors.

Following the review of this GMP, the County requested that the Design Team re-evaluate the design. This repositioning of the design intent as the 'Trailhead' sought to substantially change the prior scope of work and focus on improvements to the circulation around the COB3 and Hall of Justice.

PDU requested that Truebeck provide constructability and budgeting support. Truebeck spent nearly two months iterating design concepts and provided real-time budgets to support design ideas.

On 8/13/2024, Truebeck was directed to HOLD on the Promenade work indefinitely. The contents of this PCO reflect the committed costs Truebeck incurred up to the point that the direction to stop work was received.



Additionally, the following scopes of work previously including, but not limited to, were directed to be covered by the promenade improvements and shall be included in the COB3 project (Truebeck project 418017.300):

- CCIP Committed Cost (Value: \$479,480)
- Hall of Justice Drainage.
- Flag Pole installation and all associated electrical, civil, and structural improvements.
- Fire Hydrant Adjustments.
- Truebeck General Conditions and General Requirements for previously overlapping schedule.
- CSI Electrical Design (Credit to County).

**Entitlement:**

The cost of canceling the work is attributed to the County. Truebeck understood that this work would proceed upon finalization of the design and agreement on the corresponding GMP. The costs included in this change were approved, agreed to, and directed by the County in the time leading up to the GMP.

**\*\*11/26/24 - BRI costs adjusted to match actual.**

**ATTACHMENTS:**

#	Cost Code	Description	Type	Amount
1	901-000903 - Builders Risk	Builder's Risk Committed Cost - Promenade Cancellation	General Liability Insurance	\$27,753.00
2	100-001000 - Preconstruction	Truebeck Preconstruction Services Committed Cost	Labor	\$129,502.00
3	110-001102 - Sr. Project Manager	Truebeck Management - Promenade Closeout (40 hours)	Labor	\$7,188.00
CURRENT SPM RATE OF \$179.63/HR (Escalated rate)			Subtotal:	\$164,443.00
			Fee ( ≈ 2.75%):	\$4,522.00
			Construction Contingency (0.00%):	\$0.00
			Builder's Risk (0.00%):	\$0.00
			Grand Total:	\$168,965.00

Adjustment cost:    TBD    ADD    DEDUCT                      schedule impact:    YES    NO    TBD

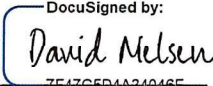
Owner/County      DocuSigned by:  
  
7F47C5B4A34046F...  
(Signature)      David Nielsen

Jan-29-2025 | 06:14 PST  
(Date)

DS  



Prime Contract Potential Change Order #5533: Promenade Cancellation

TO:	County of San Mateo - Project Development Unit 555 County Center, Second Floor Redwood City California, 94063	FROM:	Truebeck Construction 2855 Campus Drive Suite 100 San Mateo California, 94403
PROJECT:	418017.300 - SMC-COB3 Phase 2 555 County Center Redwood City, California 94063	CONTRACT:	1 - SMC-COB3 Phase 2 Prime Contract
PCO NUMBER/REVISION:	5533 / 2	CREATED DATE:	9/5 /2024
CREATED BY:	Will Levin (Truebeck Construction)	TOTAL AMOUNT:	\$168,965.00
SCHEDULE IMPACT:			

POTENTIAL CHANGE ORDER DESCRIPTION: (The Contract Is Changed As Follows)

CE #5533 - Promenade Cancellation

Description

The County directed Truebeck to prepare a GMP for a new project called the 'Promenade' for improvements across the site including, but not limited to, new walkways, paving, signage, lighting, landscaping, and civil improvements. This process began in January 2024. Between January and June of 2024, Truebeck provided budgeting support, constructability review, and site investigations which resulted in a GMP. This pricing package was planned as a change order the Truebeck's Master Agreement and COB3 work. The 6th revision of the GMP was published to the County on 6/17/2024 for approval by the Board of Supervisors.

Following the review of this GMP, the County requested that the Design Team re-evaluate the design. This repositioning of the design intent as the 'Trailhead' sought to substantially change the prior scope of work and focus on improvements to the circulation around the COB3 and Hall of Justice. PDU requested that Truebeck provide constructability and budgeting support. Truebeck spent nearly two months iterating design concepts and provided real-time budgets to support design ideas.

On 8/13/2024, Truebeck was directed to HOLD on the Promenade work indefinitely. The contents of this PCO reflect the committed costs Truebeck incurred up to the point that the direction to stop work was received.

Additionally, the following scopes of work previously including, but not limited to, were directed to be covered by the promenade improvements and shall be included in the COB3 project (Truebeck project 418017.300):

- CCIP Committed Cost (Value: \$479,480)
- Hall of Justice Drainage.
- Flag Pole installation and all associated electrical, civil, and structural improvements.
- Fire Hydrant Adjustments.
- Truebeck General Conditions and General Requirements for previously overlapping schedule.
- CSI Electrical Design (Credit to County).

Entitlement

The cost of canceling the work is attributed to the County. Truebeck understood that this work would proceed upon finalization of the design and agreement on the corresponding GMP. The costs included in this change were approved, agreed to, and directed by the County in the time leading up to the GMP.

\*\*11/26/24 - BRI costs adjusted to match actual.

ATTACHMENTS:

#	Cost Code	Description	Type	Amount
1	901-000903 - Builders Risk	Builder's Risk Committed Cost - Promenade Cancellation	General Liability Insurance	\$27,753.00
2	100-001000 - Preconstruction	Truebeck Preconstruction Services Committed Cost	Labor	\$129,502.00



PCO #5533

#	Cost Code	Description	Type	Amount
3	110-001102 - Sr. Project Manager	Truebeck Management - Promenade Closeout (40 hours)	Labor	\$7,188.00
CURRENT SPM RATE OF \$179.69/HR (Escalated rate)			Subtotal:	\$164,443.00
			Fee ( ≈ 2.75%):	\$4,522.00
			Construction Contingency (0.00%):	\$0.00
			Builder's Risk (0.00%):	\$0.00
			Grand Total:	\$168,965.00

Signed by:  
  
BFA5C319AF35492...

Jan-29-2025 | 11:05 PST

DocuSigned by:  
  
7B45E330D7A4438

Jan-29-2025 | 08:17 PST

DocuSigned by:  
  
EE1D7F4D072C402...

Jan-29-2025 | 11:13 PST

SIGNATURE

DATE

SIGNATURE

DATE

Preconstruction



Precon Start Date	12/1/2023
Precon End Date	2/15/2024
Use Weeks/Months	Months (4 weeks)

\*Months (4 weeks)

Department	Position	Employee Name	Phase	Period End:		12/24	1/21	2/18	3/17	4/14	Labor	MEOs	TOTAL
				Total Hrs.									
Precon	Estimator	Teresa McArdle	RATE = \$160/HR	314		35	87	87	70	35	\$50,240	\$7,887	\$58,127
Precon	Cost Engineer	Robie Camaquin	RATE = \$105/HR	565		80	173	173	104	35	\$59,325	\$6,844	\$66,169
Precon	Chief Estimator	Todd Ahern	RATE = \$260/HR	18			9	9			\$4,680	\$527	\$5,207
TOTAL PRECONSTRUCTION:				897		115	269	269	174	70	\$114,245	\$15,257	\$129,502

THESE ARE TRUEBECK'S STANDARD  
RATES WHICH WERE USED FOR THIS  
INITIAL ESTIMATE.





**PARKER  
SMITH  
& FEEK**  
An IMA Company

# Parker Smith & Feek Insurance LLC

-----INVOICE-----

**RE:Truebeck Construction Inc.**

**Truebeck Construction Inc.  
2855 Campus Drive, Suite 100  
San Mateo, CA 94403**

<b>Invoice</b>	<b>352930</b>
Client Code	Page
TRUECON-01	1 of 1
Balance Due on	Date Invoiced
Upon Receipt	5/23/2024
Amount Paid	Amount Due
	\$27,753.00
Pay Online: <a href="https://ima.epaypolicy.com">https://ima.epaypolicy.com</a>	

Builders Risk / Installation Floater		Policy#: CRT0515748	Term: 5/1/2024 to 12/31/2024	
Item #	Effective Date	Due Date	Description	Amount
2637408	5/1/2024	5/23/2024	County Center Public Circulation Promenade COB3	\$27,753.00
Total Invoice Balance:				\$27,753.00

<p align="center"><b>Easy Secure Online Payments via ACH or Credit Card</b>  Visit: <a href="https://ima.epaypolicy.com">https://ima.epaypolicy.com</a></p> <ul style="list-style-type: none"> <li>- Fastest option for IMA to receive and post payments</li> <li>- Receipt immediately sent following the transaction</li> <li>- No Fees for ACH Transactions</li> <li>- 3.5% fee for Credit Card Transactions</li> </ul>	
<p><b>Wire/ACH Transfer:</b></p> <p>JP Morgan Chase Bank, N.A.  3 Park Plaza, Suite 900  Irvine, CA 92612  Routing Number: 102001017  Account Number: 733272659  Email: <a href="mailto:payments@imacorp.com">payments@imacorp.com</a>  (Indicate invoice # and Finance Quote # if applicable)</p>	<p><b>Mail to:</b></p> <p>Parker Smith &amp; Feek Insurance, LLC  PO Box 102833  Pasadena, CA 91189-2833</p> <p>Please include invoice # and Finance Quote # if applicable.</p>



## David Nielsen

---

**From:** James Mosier  
**Sent:** Tuesday, January 28, 2025 1:28 PM  
**To:** Paul Hundal; David Nielsen; Sam Lin; David Nielsen  
**Cc:** daniel@cobaltbuilt.com  
**Subject:** Re: PCO 5533 - Promenade Cancellatation R2.1.pdf

David,

The back-up is acceptable if the merit is good. I would also include this email thread.

Jim

*Jim Mosier - Owner*

*Advanced Management and Consulting, LLC.*

*(510) 509-5937*

---

**From:** Paul Hundal <ahundal@smcgov.org>  
**Sent:** Tuesday, January 28, 2025 3:21 PM  
**To:** David Nielsen <c\_dnielsen@smcgov.org>; Sam Lin <slin@smcgov.org>; James Mosier <c\_jmosier@smcgov.org>; David Nielsen <davidnielsen@cobaltbuilt.com>  
**Cc:** daniel@cobaltbuilt.com <daniel@cobaltbuilt.com>  
**Subject:** RE: PCO 5533 - Promenade Cancellatation R2.1.pdf

David, Majority of the promenade work happened prior to me joining the team. I will defer to yours and Sam's assessment on the right number of hours.

Regards,  
Paul

---

**From:** David Nielsen <c\_dnielsen@smcgov.org>  
**Sent:** Tuesday, January 28, 2025 12:47 PM  
**To:** Sam Lin <slin@smcgov.org>; James Mosier <c\_jmosier@smcgov.org>; David Nielsen <davidnielsen@cobaltbuilt.com>  
**Cc:** Paul Hundal <ahundal@smcgov.org>; daniel@cobaltbuilt.com  
**Subject:** RE: PCO 5533 - Promenade Cancellatation R2.1.pdf

Thanks Sam.

Paul – Any thoughts?

Jim – In your opinion/review, do you feel the “backup” is sufficient to support the CO. I can confirm and support the hours/durations.

Thanks,

-David

---

**From:** Sam Lin <[slin@smcgov.org](mailto:slin@smcgov.org)>

**Sent:** Monday, January 27, 2025 11:37 AM

**To:** James Mosier <[c\\_jmosier@smcgov.org](mailto:c_jmosier@smcgov.org)>; David Nielsen <[c\\_dnielsen@smcgov.org](mailto:c_dnielsen@smcgov.org)>; David Nielsen <[davidnielsen@cobaltbuilt.com](mailto:davidnielsen@cobaltbuilt.com)>

**Cc:** Paul Hundal <[ahundal@smcgov.org](mailto:ahundal@smcgov.org)>; [daniel@cobaltbuilt.com](mailto:daniel@cobaltbuilt.com)

**Subject:** RE: PCO 5533 - Promenade Cancellation R2.1.pdf

I think based on many iterations we made for the 3 months duration, I am OK to approve.

Thanks,

**Sam Lin**

Project Development Unit

Interim Director

County of San Mateo

(408) 391-5150

[slin@smcgov.org](mailto:slin@smcgov.org)

500 County Center, 5th floor

Redwood City, CA 94063

---

**From:** James Mosier <[c\\_jmosier@smcgov.org](mailto:c_jmosier@smcgov.org)>

**Sent:** Monday, January 27, 2025 11:17 AM

**To:** David Nielsen <[c\\_dnielsen@smcgov.org](mailto:c_dnielsen@smcgov.org)>; David Nielsen <[davidnielsen@cobaltbuilt.com](mailto:davidnielsen@cobaltbuilt.com)>

**Cc:** Sam Lin <[slin@smcgov.org](mailto:slin@smcgov.org)>; Paul Hundal <[ahundal@smcgov.org](mailto:ahundal@smcgov.org)>; [daniel@cobaltbuilt.com](mailto:daniel@cobaltbuilt.com); Luke Davis <[c\\_ldavis@smcgov.org](mailto:c_ldavis@smcgov.org)>; Amy Allen <[c\\_aallen@smcgov.org](mailto:c_aallen@smcgov.org)>; [amy@cobaltbuilt.com](mailto:amy@cobaltbuilt.com)

**Subject:** Re: PCO 5533 - Promenade Cancellation R2.1.pdf

All,

I have a difficult time giving a blanket approval when I did not live this change. Based on our conversations it appeared you were good with the hours, if that is the case then we have done our job and I would think you could push it up the chain.

Sam/Paul - any thoughts?

Jim

---

**From:** David Nielsen <[c\\_dnielsen@smcgov.org](mailto:c_dnielsen@smcgov.org)>

**Sent:** Monday, January 27, 2025 1:00 PM

**To:** David Nielsen <[davidnielsen@cobaltbuilt.com](mailto:davidnielsen@cobaltbuilt.com)>; James Mosier <[c\\_jmosier@smcgov.org](mailto:c_jmosier@smcgov.org)>

**Cc:** Sam Lin <[slin@smcgov.org](mailto:slin@smcgov.org)>; Paul Hundal <[ahundal@smcgov.org](mailto:ahundal@smcgov.org)>;

[daniel@cobaltbuilt.com](mailto:daniel@cobaltbuilt.com) <[daniel@cobaltbuilt.com](mailto:daniel@cobaltbuilt.com)>; Luke Davis <[c\\_ldavis@smcgov.org](mailto:c_ldavis@smcgov.org)>; Amy Allen

<[c\\_aallen@smcgov.org](mailto:c_aallen@smcgov.org)>; [amy@cobaltbuilt.com](mailto:amy@cobaltbuilt.com) <[amy@cobaltbuilt.com](mailto:amy@cobaltbuilt.com)>

**Subject:** RE: PCO 5533 - Promenade Cancellation R2.1.pdf

Hello All,

Following up on this one to find the best path forward so we can finalize the promenade Amendment. I think the overall hours although high at face value are warrantable due to the fact that we spent at least 6 months on the entire process including countless design revisions and pricing exercises.

What backup would we need from TCI to support this for approval?

Thanks,

-David

---

**From:** David Nielsen <[davidnielsen@cobaltbuilt.com](mailto:davidnielsen@cobaltbuilt.com)>

**Sent:** Monday, January 13, 2025 4:45 PM

**To:** James Mosier <[jmosier@smcgov.org](mailto:jmosier@smcgov.org)>

**Cc:** David Nielsen <[dnielsen@smcgov.org](mailto:dnielsen@smcgov.org)>; Sam Lin <[slin@smcgov.org](mailto:slin@smcgov.org)>; Paul Hundal <[ahundal@smcgov.org](mailto:ahundal@smcgov.org)>; [daniel@cobaltbuilt.com](mailto:daniel@cobaltbuilt.com); Luke Davis <[ldavis@smcgov.org](mailto:ldavis@smcgov.org)>; Amy Allen <[c\\_aallen@smcgov.org](mailto:c_aallen@smcgov.org)>; [amy@cobaltbuilt.com](mailto:amy@cobaltbuilt.com)

**Subject:** Re: PCO 5533 - Promenade Cancellation R2.1.pdf

**CAUTION:** This email originated from outside of San Mateo County. Unless you recognize the sender's email address and know the content is safe, do not click links, open attachments or reply.

---

Thanks Jim, please see my comments below in red. Additionally, I know that there were months of back and forth trying to reduce the design, changing scope, etc..

Daniel - Any additional insight you would like to provide?

Thanks,

-David

On Thu, Jan 9, 2025 at 3:49 PM James Mosier <[jmosier@smcgov.org](mailto:jmosier@smcgov.org)> wrote:

David,

I have a hard time buying into the amount of hours they are showing for estimating (332 hours) and cost engineer (565 hours) if the work is limited to just the Promenade, not knowing the entire picture the pricing appears lofty for the scope needed. That is 2 months plus for estimating) and 14 + full-time weeks for the cost engineer. Additionally, the \$15K in MEOs are all overhead items and not allowed per contract, at SMMC we made them remove them all.

I think the only way to verify is to do a deep dive into the pay apps and see when/if they were previously charged during that time frame, etc.

Question - how many estimates did they do? **There was the initial full GMP with scoping docs, bid solicitations, bid reviews, etc.. After that, I think we made it to REV 6 (or so) with months of back and forth which took us from the original documented design, to a more selective scope and a completely**



new design from the architect all together. It was a very iterative process and TCI had a lot of burn running pricing exercises for us.

Question - Do you agree the Cost Engineer spent 565 hours on the promenade entirely? - I would say that over the lifespan of the Promenade pricing, approx. 3 months is in the realm of relaiity.

Question - Is the additional Sr PM time justified? - I feel that the additional Sr. PM time is warranted as Will spent a lot of time in the new design reviews for cost and feasibility.

Jim

*Jim Mosier - Owner*

*Advanced Management and Consulting, LLC.*

*(510) 509-5937*

---

**From:** David Nielsen <[c\\_dnielsen@smcgov.org](mailto:c_dnielsen@smcgov.org)>

**Sent:** Monday, January 6, 2025 1:28 PM

**To:** James Mosier <[c\\_jmosier@smcgov.org](mailto:c_jmosier@smcgov.org)>

**Cc:** Sam Lin <[slin@smcgov.org](mailto:slin@smcgov.org)>; Paul Hundal <[ahundal@smcgov.org](mailto:ahundal@smcgov.org)>;  
[daniel@cobaltbuilt.com](mailto:daniel@cobaltbuilt.com) <[daniel@cobaltbuilt.com](mailto:daniel@cobaltbuilt.com)>; [davidnielsen@cobaltbuilt.com](mailto:davidnielsen@cobaltbuilt.com) <[davidnielsen@cobaltbuilt.com](mailto:davidnielsen@cobaltbuilt.com)>;  
Luke Davis <[ldavis@smcgov.org](mailto:ldavis@smcgov.org)>; Amy Allen <[c\\_aallen@smcgov.org](mailto:c_aallen@smcgov.org)>;  
[amy@cobaltbuilt.com](mailto:amy@cobaltbuilt.com) <[amy@cobaltbuilt.com](mailto:amy@cobaltbuilt.com)>

**Subject:** PCO 5533 - Promenade Cancellatation R2.1.pdf

Hello Jim, hope the holidays found you well.

Can you please review the attached which finalizes TCI's costs for the canceled Promenade scope?

Some history on this is that originally TCI was given direction to proceed with full precon on the promenade scope and compiled a complete "GMP" package for the work before it was placed on hold. This included full scope documents, bid solicitation, reviews, assembly, countless rounds of back and forth with our team honing the price, etc. In discussion with Adam and Sam we directed TCI to extend the Builders Risk coverage in anticipation of the work. In my opinion, the hours seem within range of the time they spent on the procon side. Please let me know your thoughts and if you have any questions.

Thanks,

-David



**PCCO #5475– Truebeck : CE #5475: Campus Infrastructure Engineering drawings**

PDP01 COB3 Truebeck 84700-24-R080465

**Owner:**

County Manager's Office  
555 County Center Floor 2  
Redwood City, CA 94063

**Date: July 18, 2024**

**Change Order Title:** PDP01 COB3 Truebeck 84700-84-R080465 CE #5475 Campus Infrastructure Engineering drawings

**REF: Cost Proposal Listed**

**DISPOSITION:**

- ☒ Approved  
☐ Rejected

**NARRATIVE:**

x See attached documents

The PDU has reviewed Truebeck Change Order Request #5475 and this change order request is approved for full and final amount of **\$10,971.00** for all labor, material, equipment, and incidentals whether direct or indirect to provide the scope described herein.

**POTENTIAL CHANGE ORDER DESCRIPTION: (The Contract Is Changed As Follows)**

**CE #5475 - Campus Infrastructure Engineering drawings**

**Scope:**

Engineering for promenade scope for CSI Electrical need to complete the Campus Infrastructure drawings. Work will be credited from the Campus Infrastructure project.

**Entitlement:**

Add to GMP, need to complete the Campus Infrastructure drawings.

**Source of Funding:**

Add to GMP. Will be tracked out of the Promenade/Campus Infrastructure

#	Cost Code	Description	Type	Amount
1	326-260000 - Electrical	RFC 205 - Promenade Engineering drawings	Subcontract	\$10,005.00
Subtotal:				\$10,005.00
Fee ( ≈ 2.75%):				\$275.00
Construction Contingency (3.00%):				\$300.00
Builder's Risk ( ≈ 3.91%):				\$391.00
Grand Total:				\$10,971.00

Adjustment:

cost:    TBD    ADD    DEDUCT                      schedule impact:    YES    NO    TBD

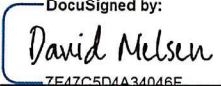
Owner/County    DocuSigned by:  
  
7E47C5D4A34046E...  
\_\_\_\_\_  
(Signature)    David Nielsen

Jul-19-2024 | 07:50 PDT  
\_\_\_\_\_  
(Date)

DS  



PCO #5475

## Prime Contract Potential Change Order #5475 : CE #5475 - Campus Infrastructure Engineering drawings

TO:	County of San Mateo - Project Development Unit 555 County Center, Second Floor Redwood City California, 94063	FROM:	Truebeck Construction 2855 Campus Drive Suite 100 San Mateo California, 94403
PROJECT:	418017.300 - SMC-COB3 Phase 2 555 County Center Redwood City, California 94063	CONTRACT:	1 - SMC-COB3 Phase 2 Prime Contract
PCO NUMBER/REVISION:	5475 / 0	CREATED DATE:	5/8 /2024
CREATED BY:	Marco Innocenti (Truebeck Construction)	TOTAL AMOUNT:	\$10,971.00
SCHEDULE IMPACT:	0 days		

### POTENTIAL CHANGE ORDER DESCRIPTION: *(The Contract Is Changed As Follows)*

CE #5475 - Campus Infrastructure Engineering drawings

Scope:  
Engineering for promenade scope for CSI Electrical need to complete the Campus Infrastructure drawings. Work will be credited from the Campus Infrastructure project.

Entitlement:  
Add to GMP, need to complete the Campus Infrastructure drawings.

Source of Funding:  
Add to GMP. Will be tracked out of the Promenade/Campus Infrastructure

### ATTACHMENTS:

#	Cost Code	Description	Type	Amount
1	326-260000 - Electrical	RFC 205 - Promenade Engineering drawings	Subcontract	\$10,005.00
Subtotal:				\$10,005.00
Fee ( ≈ 2.75%):				\$275.00
Construction Contingency (3.00%):				\$300.00
Builder's Risk ( ≈ 3.91%):				\$391.00
Grand Total:				\$10,971.00

DocuSigned by:  
  
8B21E53957F04E7...

Jul-25-2024 | 09:09 PDT

DocuSigned by:  
**Will Levin**  
B8047DA65124A475...

Jul-22-2024 | 14:04 PDT

SIGNATURE

DATE

DocuSigned by:  
  
EE1B7F4D372C432...

Jul-22-2024 | 14:20 PDT

SIGNATURE

DATE





# CHANGE ORDER REQUEST

**Truebeck Construction**  
 Attn.: Marco Innocenti  
 951 Mariners Island Blvd, Suite 700  
 San Mateo, CA 94404 94404

RFC# 205  
 Date: 4/10/2024  
 Project Name: San Mateo COB3  
 Project Number: 210762.07  
 Page Number: 1

**Description of Work:**

San Mateo County Office Building 3  
 San Mateo, CA

Summary: PCO ???? - RFC 207 - Promenade Engineering drawings

**Scope of work**  
 ·Engineering for promenade scope

NOTE, QUALIFICATIONS, CLARIFICATIONS, & EXCLUSIONS:

- Pricing is good for 30 days only. CSI reserves the right to re-price the entirety of added scope should a change order is not received/executed within 30 days.
- Painting/Patching is excluded
- Proposal priced will be performed on Normal time.

If you have any questions, or if the above scope does not agree with your interpretation of the scope, plans and specifications, please do not hesitate to contact us.

Upon receiving a Change Order in the amount below, CSI will proceed with this revision/additional scope of work.

Pricing of this work is limited to the scope of work defined above and as described within. This pricing does not include costs related to differing site conditions, unforeseen delays in prosecuting the work, interference by other trades, performing the scope during non-standard working hours at overtime or premium rates (unless specifically included), nor performing work not specifically identified or related to the specific scope of "electrical" work defined within this change order request. We reserve the right to correct this quote for errors and omissions.

**Itemized Material Breakdown**

**Price Summary**

<b>LABOR</b>		
ENGINEERING	(60.00 Hrs @ \$145.00)	8,700.00
<b>Indirect Labor Subtotal</b>		8,700.00
<b>Total Labor</b>		8,700.00
<b>Subtotal</b>		8,700.00
Markup	(@ 15.000 %)	1,305.00
<b>Final Amount</b>		<b>\$10,005.00</b>