

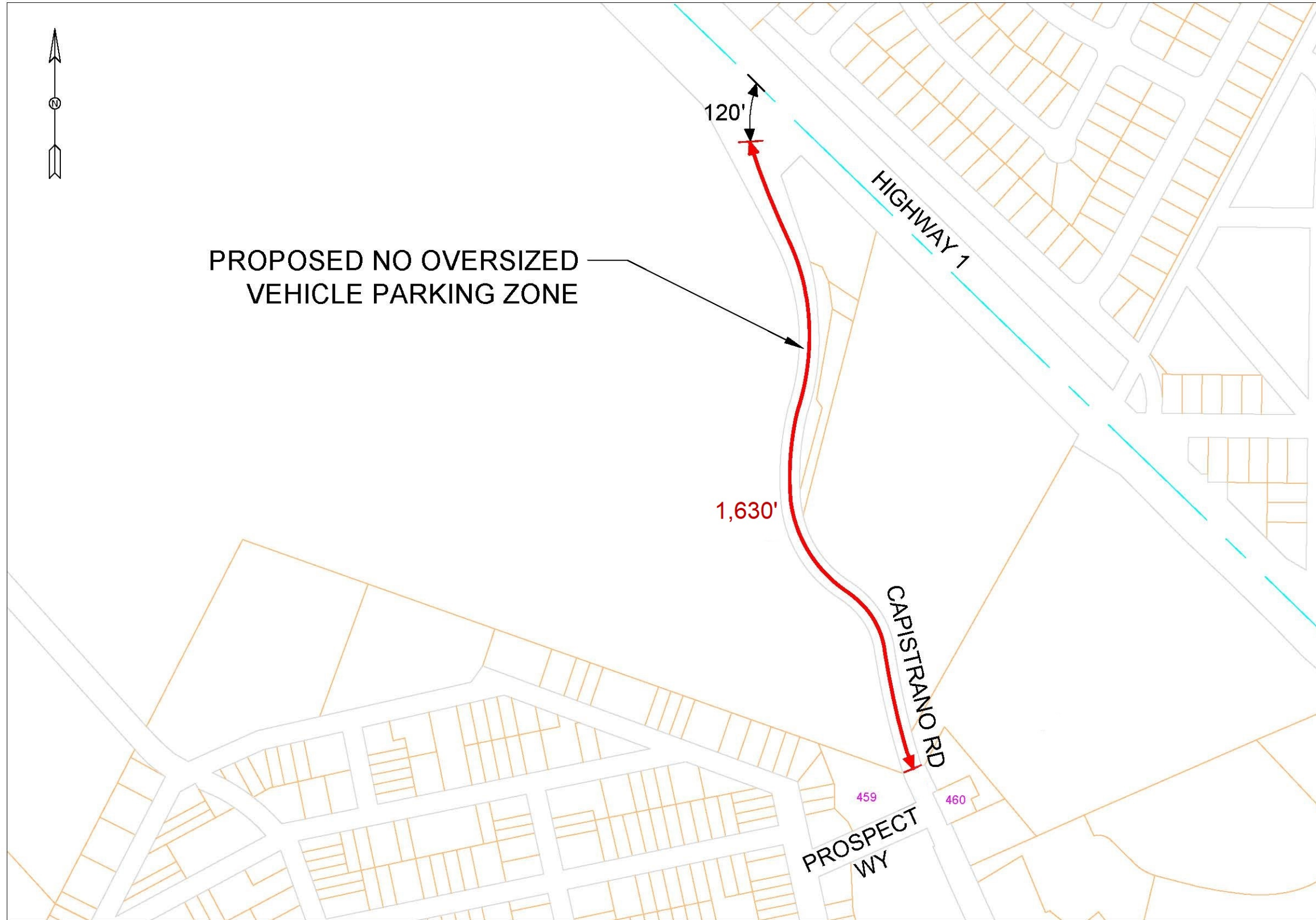

APPROVED: 4/28/2026
 DATE: 4/28/2026
 KRZYSZTOF LISAJ
 COUNTY ENGINEER
 R. C. E. # 84003



R28D (CA)
 18"x18"

**NO OVERSIZED VEHICLE PARKING ZONE ON CAPISTRANO ROAD
 EXHIBIT A**



DESIGNED BY: ID		NO OVERSIZED VEHICLE PARKING ZONE	SCALE: NTS
CHECKED BY: TC		ON CAPISTRANO ROAD IN UNINCORPORATED HALF MOON BAY	DATE: 4/24/2026
DRAWN BY: ID		SIGNAGE PLANS	FILE NO:
REVISION	DATE	TORY A. NEWMAN, DIRECTOR OF PUBLIC WORKS COUNTY OF SAN MATEO	555 COUNTY CENTER, 8th FLOOR REDWOOD CITY, CALIFORNIA 94063
			SHEET 1 OF 1

FILENAME: C:\USERS\DEGRACA\DESKTOP\CAPISTRANO RD SITE PLAN.DWG (NO OVERSIZED PARKING ZONE)